

NOTES

1. This drawing must only be used for the purposes intended and must not be scaled; only written or calculated dimensions to be used.
2. All hand made cast stone supplied by Amber Valley Stone confirms to:
 - a) BS1217 (2008)
 - b) CAT weathering class
3. Amber Valley Stone heads are decorative only and not structural, a structural lintel will be required.
4. All steelwork fixings and details are to be designed and supplied by others (unless stated otherwise)
5. Fixing methods shown in any Amber Valley Stone drawing are suggestions only and must be checked by a structural engineer. Amber Valley Stone cannot be held responsible for fixing / supporting methods.
6. Cast-in sockets for lifting MUST only be used for lifting within a vertical plane. See manufacturer's literature – available from Amber Valley Stone – for correct usage.
7. Technical data sheets and guidance notes are available from Amber Valley Stone on request.
8. All dowel holes to be drilled on site by others unless stated otherwise.

Revision Details	Initial	Date	Suffix



AMBER VALLEY STONE
 Amber Valley Stone Ltd
 West Way, Somercotes, Derbyshire, DE55 4QJ
 Tel: 01773 540707
 Website: www.ambervalleystone.co.uk
 Company e-mail: info@ambervalleystone.co.uk

Client

Project

Title

Drawn	Checked	Date	Scale
			1:10

Project Manager

Email @ambervalleystone.co.uk

Project No.

Drawing No.	Rev.

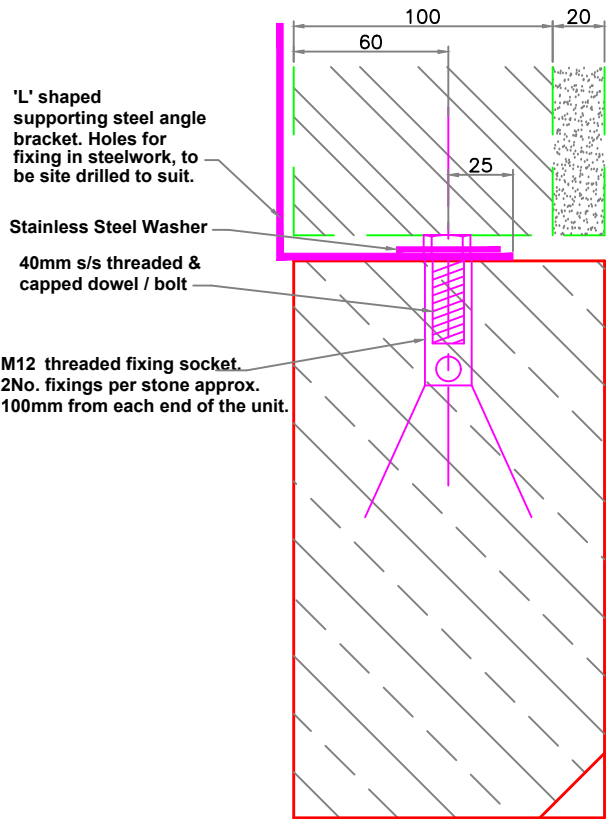

'L' shaped supporting steel angle bracket. Holes for fixing in steelwork, to be site drilled to suit.

Stainless Steel Washer

40mm s/s threaded & capped dowel / bolt

M12 threaded fixing socket. 2No. fixings per stone approx. 100mm from each end of the unit.

Top Hanging Restraint Detail

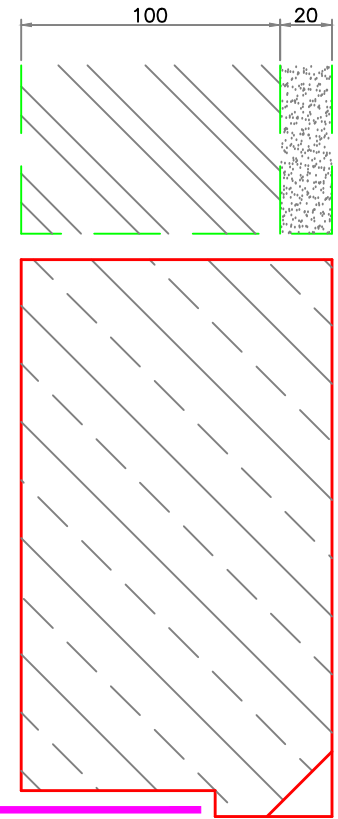

'L' shaped supporting steel angle bracket. Head to be pistolled to cloak face of steel.

Underside Support Detail

PLEASE NOTE

1. THE FIXING DETAIL SHOWN IS A SUGGESTION ONLY
2. ALL FIXING DETAILS ARE TO BE CHECKED, SUPPLIED & FIXED BY OTHERS
3. 'L' SHAPED BRACKET IS A GRAPHICAL REPRESENTATION ONLY AND CAN BE ANY SORT OF LINTEL WITH A PROTRUDING TOE.